

$\varnothing d$	$\varnothing d_1$	h	$\varnothing D$	$\varnothing d$	$\varnothing d_1$	h	$\varnothing D$
2.9	4.6	9.5	7.9	35.9	40.2	24.5	44.1
4.4	6.1	9.5	9.5	36.3	38.3	12.0	42.3
4.7	8.5	22.5	11.7	36.9	40.6	22.5	44.0
5.6	7.0	8.4	10.5	38.6	40.6	12.7	44.5
6.2	7.6	9.5	11.1	39.6	42.7	18.5	47.6
7.7	9.1	9.5	12.7	40.8	44.7	24.0	49.0
7.7	9.3	8.0	12.7	41.4	44.8	19.0	49.2
8.4	10.0	9.5	13.5	42.5	44.8	12.6	50.7
8.5	10.0	11.0	14.0	43.4	48.5	24.5	53.3
8.6	10.3	9.8	13.7	44.1	46.7	18.4	49.8
9.0	10.7	11.5	13.9	45.0	49.0	26.0	54.0
9.3	11.2	11.0	14.5	45.2	49.0	24.5	53.4
9.4	10.8	8.5	14.0	45.9	46.3	9.5	50.8
10.0	11.8	9.5	15.0	46.0	50.0	24.8	54.0
10.4	12.2	11.0	18.0	47.2	51.9	24.0	55.8
10.6	12.2	9.8	15.6	47.5	50.3	25.0	54.0
10.9	12.3	9.3	15.9	48.0	52.7	25.4	57.1
11.2	14.0	18.5	17.5	48.6	51.2	18.7	55.5
11.3	12.9	8.5	16.3	49.8	54.0	24.3	58.0
11.3	13.0	11.0	17.0	51.1	54.4	25.0	57.0
11.3	13.2	11.0	17.0	51.5	54.1	18.5	58.3
11.5	13.0	9.5	16.7	53.5	57.0	25.1	62.4
12.0	14.0	13.0	18.0	54.0	58.4	24.5	62.4
12.0	14.8	11.0	17.5	55.0	61.0	25.0	65.0
12.1	13.9	11.0	17.5	55.4	58.8	25.1	65.0
12.5	14.0	8.9	17.5	57.5	57.6	12.8	63.6
12.8	15.1	23.1	18.5	59.3	67.3	31.7	70.3
13.6	15.3	11.2	19.0	59.6	62.6	24.6	66.7
14.2	16.0	12.1	19.0	62.0	66.4	28.0	71.0
14.7	17.0	12.7	20.6	63.3	69.8	25.4	73.0
14.9	16.4	11.5	21.0	64.5	67.3	15.8	70.6
15.5	17.1	8.5	20.6	68.1	70.9	19.0	74.6
16.0	18.3	14.1	22.0	70.0	75.8	25.4	79.4
16.1	17.6	8.5	21.0	74.0	76.8	24.4	80.0
16.4	18.3	12.3	22.2	74.0	77.0	18.7	82.5
16.6	18.5	13.0	21.9	76.8	82.2	25.4	85.7
17.2	20.2	18.0	24.2	77.1	80.7	19.0	85.7
17.7	19.6	12.7	22.2	80.0	86.1	25.1	89.8
17.8	20.0	13.4	23.8	84.2	90.8	28.0	94.5
18.3	21.4	17.5	25.4	85.3	88.0	19.0	92.0
18.5	20.9	14.3	24.6	87.5	93.6	34.3	96.7
19.0	21.5	14.3	25.8	88.1	93.3	28.6	96.5
19.4	22.5	19.0	26.5	92.1	97.0	32.0	100.0
20.5	23.2	17.5	27.2	93.5	100.3	26.5	107.5
21.2	23.2	12.3	27.3	94.5	100.6	34.5	103.6
21.3	23.2	15.9	27.0	96.5	102.0	31.0	110.0
22.0	25.0	15.9	28.5	98.0	102.0	24.7	107.2
22.5	25.5	17.8	28.9	98.2	103.3	28.8	106.0
22.7	24.9	12.0	27.0	101.9	107.5	28.6	109.0
23.4	26.4	17.5	29.3	106.7	111.7	28.6	113.3
24.0	26.9	18.0	31.0	108.0	114.1	35.2	118.5
24.6	29.5	27.5	34.0	111.5	117.6	35.0	122.0
24.7	27.7	19.0	32.0	112.1	114.3	28.6	116.8
26.6	29.7	26.3	31.6	124.0	128.0	23.0	134.0
28.0	30.9	19.0	35.3	129.0	135.1	36.5	139.5
29.2	31.2	12.7	34.7	133.0	137.0	22.0	143.0
30.0	32.6	15.2	36.7	139.5	145.6	36.5	150.0
30.5	33.3	14.5	37.0	141.0	150.0	25.4	164.0
31.1	34.3	17.5	38.1	146.8	152.6	33.0	159.5
31.1	34.4	19.0	38.1	153.7	161.5	29.6	178.9
31.6	36.3	24.1	40.2	157.0	163.0	36.5	167.5
33.3	34.4	9.5	38.1	202.9	203.8	32.7	218.7
33.3	37.2	22.2	41.6	203.5	208.5	24.0	216.0
33.9	37.3	12.3	42.2	216.0	223.6	29.1	241.5
33.9	38.3	24.5	42.3	252.2	257.8	33.8	272.5
34.9	36.4	8.2	42.7	304.2	308.4	33.9	322.6

Zátky kruhové kónické a válcové Typ: 004-388-d/d₁xh
Materiál: PE; Barva: přírodní

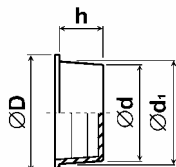

$\varnothing d$	$\varnothing d_1$	h	$\varnothing D$	$\varnothing d$	$\varnothing d_1$	h	$\varnothing D$
2.5	3.3	4.6	7.0	58.5	60.0	13.5	64.0
5.0	5.6	3.8	8.3	60.5	61.5	13.5	66.0
6.8	8.0	4.5	10.5	61.3	63.7	13.5	67.0
8.1	9.3	7.0	11.0	62.5	63.6	13.5	68.0
9.8	10.5	7.0	12.0	63.5	64.5	13.0	69.0
10.6	11.8	7.0	14.0	65.0	66.3	13.0	71.0
11.4	12.6	7.0	15.0	66.0	67.8	13.0	72.0
13.3	14.5	7.0	16.0	67.9	68.5	13.0	74.0
14.0	15.2	7.0	17.0	69.8	70.9	13.0	75.0
14.6	15.2	7.0	18.0	71.5	73.5	13.0	77.0
15.3	15.8	7.0	18.0	72.8	75.0	13.0	79.0
16.0	17.2	9.0	20.0	74.0	75.2	13.0	85.0
17.4	18.8	9.0	21.0	76.5	78.6	17.0	87.0
18.2	19.6	9.0	22.0	77.5	79.7	17.0	88.0
18.7	20.0	9.0	24.0	79.0	81.1	17.0	90.0
19.8	21.2	9.0	24.0	81.5	82.3	17.0	92.0
20.3	22.6	14.0	25.0	84.0	87.0	17.0	95.0
21.2	23.3	14.0	26.0	86.5	88.3	17.0	97.0
23.0	25.0	14.0	28.0	89.0	92.0	17.0	100.0
24.3	26.4	14.0	30.0	91.5	94.3	17.0	102.0
25.7	27.8	14.0	30.0	94.0	96.4	17.0	105.0
27.2	29.3	14.0	32.0	96.5	99.5	17.0	107.0
30.0	32.0	14.0	35.0	99.0	101.2	17.0	110.0
32.0	34.0	14.0	38.0	101.5	104.0	17.0	112.0
33.6	36.0	14.0	40.0	104.0	107.0	17.0	115.0
34.5	37.0	14.0	41.0	106.5	109.5	17.0	117.0
36.0	38.4	14.0	42.0	109.0	112.0	17.0	120.0
37.9	40.0	14.0	44.0	112.0	115.0	17.0	123.0
38.5	41.0	14.0	43.0	114.0	117.0	17.0	125.0
39.8	42.0	14.0	46.0	119.0	123.0	23.0	130.0
41.3	43.5	14.0	47.0	124.0	128.0	23.0	134.0
43.9	46.3	13.5	52.0	127.5	131.5	23.0	137.6
45.5	47.9	13.5	52.0	129.0	133.0	23.0	140.0
47.9	49.0	13.5	54.0	133.0	137.0	23.0	143.0
49.8	51.2	13.5	56.0	139.0	143.0	23.0	149.0
50.5	51.5	14.0	55.0	146.8	150.8	23.0	159.5
52.5	54.8	13.5	58.0	149.0	153.0	23.0	159.0
54.5	55.8	13.5	60.0	153.5	157.5	23.0	163.6
55.5	56.3	13.5	61.0	160.0	164.0	23.0	170.0
57.0	57.5	13.5	63.0				

Zátky kruhové kónické a válcové Typ: 004-388-d/d₁xh
Materiál: PE; Barva: žlutá

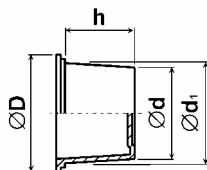

$\varnothing d$	$\varnothing d_1$	h	$\varnothing D$	$\varnothing d$	$\varnothing d_1$	h	$\varnothing D$
4.4	6.2	10.0	10.0	24.5	27.8	19.0	32.0
6.0	7.8	10.0	11.0	25.2	29.2	19.0	33.0
7.6	9.4	10.0	13.0	27.8	31.1	19.0	35.0
8.4	10.2	10.0	14.0	29.8	32.6	16.0	37.0
9.2	11.0	10.0	14.0	31.4	35.1	21.0	38.0
9.9	11.7	10.0	15.0	33.3	37.1	22.0	41.0
10.6	12.4	10.0	16.0	36.7	40.5	22.0	45.0
11.3	13.1	10.0	17.0	38.2	43.0	23.0	48.0
12.0	14.1	12.0	18.0	38.4	40.7	13.0	45.0
12.5	14.6	12.0	18.0	39.6	42.9	19.0	48.0
13.5	15.6	12.0	19.0	41.4	44.7	19.0	49.0
14.0	16.1	12.0	19.0	44.4	47.7	19.0	51.0
14.7	17.0	13.0	21.0	45.2	49.6	25.0	54.0
16.3	18.6	13.0	22.0	46.6	51.0	25.0	55.0
17.1	19.4	13.0	22.0	52.5	56.9	25.0	62.0
17.5	20.1	15.0	24.0	54.0	59.3	25.0	65.0
18.4	21.0	15.0	25.0	54.2	58.6	25.0	65.0
19.0	21.6	15.0	25.0	58.4	62.8	25.0	67.0
20.4	23.2	16.0	27.0	60.8	65.9	29.0	71.0
20.7	23.5	16.0	28.0	67.1	70.4	19.0	75.0
22.0	24.8	16.0	29.0	72.4	75.7	19.0	83.0
23.2	26.4	18.0	30.0	73.5	77.5	19.0	84.0



Zátky kruhové kónické a válcové Typ: 004-388-d/d₁xh
Materiál: PE; Barva: žlutá

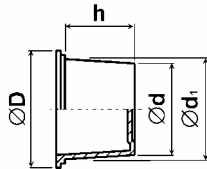

$\varnothing d$	$\varnothing d_1$	h	$\varnothing D$	$\varnothing d$	$\varnothing d_1$	h	$\varnothing D$
84.5	87.8	19.0	92.0	93.5	97.5	19.0	101.0

Zátky kruhové kónické a válcové Typ: 004-068-dxh
Materiál: PE; Barva: přírodní

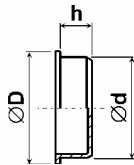

$\varnothing d$	h	$\varnothing D$	$\varnothing d$	h	$\varnothing D$	$\varnothing d$	h	$\varnothing D$
2.0	3.0	6.5	26.0	10.5	30.5	57.0	10.0	61.0
2.5	3.5	6.5	26.5	10.5	30.0	58.0	11.0	65.0
3.0	4.5	6.5	27.0	9.5	31.0	59.0	11.0	65.0
3.5	4.5	7.0	27.5	10.5	31.0	60.0	11.0	65.0
4.0	5.0	7.5	28.0	10.5	32.5	61.0	11.0	87.5
4.5	5.0	8.0	28.5	10.0	32.0	62.0	11.0	68.0
5.0	6.0	9.0	29.0	10.0	32.0	63.0	9.5	67.0
5.5	6.0	9.0	29.5	10.5	33.0	63.5	10.5	70.0
6.0	6.0	9.5	30.0	10.0	33.0	64.0	9.5	67.5
6.5	7.0	10.0	30.5	10.0	34.0	65.0	10.0	69.0
7.0	6.0	10.0	31.0	10.5	36.0	66.0	10.0	72.0
7.5	6.5	10.5	31.5	10.5	35.0	67.0	10.0	73.0
8.0	7.0	11.0	32.0	10.5	37.0	68.0	11.0	75.0
8.5	7.5	11.5	32.5	10.5	37.5	69.0	10.5	75.0
9.0	7.5	11.5	33.0	10.5	38.0	70.0	11.0	74.0
9.5	7.5	12.5	33.5	10.5	37.5	71.0	11.0	74.5
10.0	8.5	13.0	34.0	10.5	38.5	71.5	10.5	74.5
10.5	8.5	13.5	34.5	10.5	38.0	72.0	12.0	79.0
11.0	8.5	14.5	35.0	10.5	40.0	73.0	9.5	76.5
11.5	8.5	14.5	35.5	10.5	39.0	74.0	10.5	77.5
12.0	9.0	14.5	36.0	11.0	41.0	75.0	9.5	79.0
12.5	9.0	15.5	36.5	10.5	40.0	76.0	10.5	80.0
13.0	9.5	16.5	37.0	11.0	42.0	77.0	9.5	81.0
13.5	9.5	16.5	37.5	10.5	41.5	78.0	10.5	82.0
14.0	10.0	17.5	38.0	10.5	43.0	79.0	9.6	83.0
14.5	9.5	17.5	38.5	10.5	42.0	80.0	9.5	84.0
15.0	9.5	18.0	39.0	10.5	44.0	81.0	9.5	85.0
15.5	9.5	18.5	39.5	10.7	43.3	82.0	9.5	85.5
16.0	10.0	19.5	40.0	10.5	45.0	83.0	9.5	86.5
16.5	10.5	19.5	41.0	10.5	46.0	84.0	10.0	90.0
17.0	10.5	20.5	42.0	10.5	46.5	84.5	8.0	90.0
17.5	10.5	21.0	43.0	10.7	47.8	85.0	9.5	88.5
18.0	10.5	21.5	44.0	10.5	49.0	86.0	9.5	90.0
18.5	10.0	23.0	45.0	10.6	50.8	86.5	10.0	89.0
19.0	10.0	22.0	46.0	10.0	50.8	87.0	9.5	90.5
19.5	10.5	23.0	47.0	10.5	51.5	88.0	9.5	91.5
20.0	11.0	23.5	48.0	10.5	53.0	89.0	9.5	92.5
20.5	10.5	24.5	48.5	10.5	52.0	90.0	10.0	92.5
21.0	11.0	24.5	49.0	11.0	54.5	91.0	9.5	93.0
21.5	11.0	25.5	50.0	10.0	54.0	92.0	9.5	94.5
22.0	11.0	25.5	51.0	11.0	56.0	93.0	9.5	97.0
22.5	10.5	26.0	52.0	11.0	57.5	94.0	9.5	97.0
23.0	10.5	27.0	53.0	11.0	59.0	95.0	9.0	97.0
23.5	10.5	27.5	53.5	9.5	55.5	96.0	9.5	98.0
24.0	11.5	28.0	54.0	11.0	61.0	97.0	9.5	99.0
24.5	10.5	28.0	55.0	10.0	61.0	98.0	10.0	100.0
25.0	11.0	30.0	56.0	11.5	63.0	99.0	9.5	102.0
25.5	10.5	29.0	56.5	10.5	59.5	100.0	10.5	104.5



Zátky kruhové kónické a válcové Typ: 004-068-dxh
Materiál: PE; Barva: přírodní

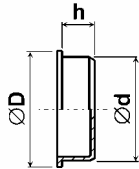

$\varnothing d$	h	$\varnothing D$	$\varnothing d$	h	$\varnothing D$	$\varnothing d$	h	$\varnothing D$
101.0	10.5	105.0	135.0	12.5	141.0	186.0	16.0	194.0
102.0	10.5	106.0	140.0	13.5	144.0	190.0	13.6	195.6
103.0	11.0	106.0	142.0	13.5	146.0	192.0	13.6	197.6
104.0	11.0	106.5	146.0	12.0	152.0	200.0	14.0	208.0
105.0	10.5	108.0	150.0	14.5	154.0	202.0	14.0	210.0
106.0	10.5	109.5	152.0	15.0	156.0	208.0	15.0	220.0
107.0	10.5	110.0	155.0	12.0	161.0	211.0	12.0	217.0
108.0	10.5	111.5	160.0	14.0	167.0	214.0	13.5	220.0
110.0	12.5	114.0	162.0	14.0	169.0	230.0	12.0	236.0
111.0	12.7	115.0	165.0	12.0	171.0	233.0	16.0	245.0
112.0	10.5	116.0	167.0	17.5	178.0	250.0	14.5	259.0
115.0	12.0	118.5	169.0	12.0	175.0	252.0	14.5	261.0
117.0	12.0	124.0	170.0	13.6	175.6	261.0	16.0	273.0
121.0	12.0	124.0	172.0	13.6	177.6	285.0	18.0	298.0
125.0	13.5	130.0	176.0	12.0	182.0	302.0	18.5	309.6
127.0	13.5	132.0	180.0	14.5	187.0	311.0	18.0	324.0
130.0	13.5	134.0	182.0	14.5	189.0			
132.0	13.0	136.5	184.0	16.0	194.0			

Zátky kruhové kónické a válcové Typ: 004a-110-dxh
Materiál: PE; Barva: přírodní

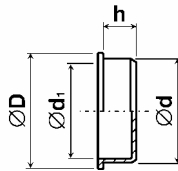

$\varnothing d$	h	$\varnothing d_1$	$\varnothing D$	$\varnothing d$	h	$\varnothing d_1$	$\varnothing D$
5.0	5.0	3.5	9.0	25.0	9.0	22.5	29.0
5.5	5.0	3.6	9.5	26.0	10.0	23.5	30.0
6.0	5.5	4.5	10.0	26.6	8.5	24.7	30.6
6.5	5.5	5.0	10.5	27.0	10.0	24.5	31.0
7.0	5.5	5.5	11.0	27.7	8.5	26.0	31.6
7.5	5.5	5.6	11.5	28.0	10.0	25.5	32.0
8.0	5.5	6.5	12.0	29.0	10.0	26.5	33.0
8.5	6.0	7.0	12.5	30.0	10.0	27.5	34.0
9.0	6.0	7.5	13.0	31.1	8.5	29.9	35.0
9.5	6.0	8.0	13.5	31.4	8.5	30.2	35.5
10.0	6.5	8.5	14.0	31.5	10.0	29.0	35.5
10.5	6.5	9.0	14.5	31.8	8.5	30.2	35.8
11.0	6.5	9.5	15.0	32.5	11.0	30.5	37.0
11.5	6.5	10.0	15.5	33.2	8.5	31.7	37.2
12.0	6.5	10.5	15.8	36.0	8.5	34.4	40.2
12.5	6.5	11.0	16.5	39.1	8.5	37.5	43.1
13.0	6.5	11.0	17.0	40.1	8.6	38.9	46.8
13.5	6.5	11.5	17.5	39.5	11.0	37.5	42.0
14.0	6.5	12.0	18.0	40.7	8.7	39.1	47.5
14.5	7.0	12.5	18.5	46.4	4.0	42.6	41.4
15.0	7.5	13.0	19.0	40.5	9.6	38.3	54.0
15.5	7.5	13.5	19.5	40.5	8.7	38.5	59.6
16.0	7.5	14.0	20.0	42.6	5.8	41.4	46.4
16.5	7.5	14.5	20.5	46.1	8.5	44.5	52.7
17.0	7.5	15.0	21.0	46.6	9.6	45.1	50.3
17.5	7.5	15.5	21.5	47.0	10.0	45.5	52.0
18.0	8.5	16.0	22.0	51.1	10.2	49.5	60.0
18.5	8.5	16.5	22.5	58.2	8.7	56.5	67.0
19.0	8.5	17.0	23.0	60.0	10.2	58.8	61.7
19.5	8.5	17.5	23.4	66.2	8.7	64.6	75.2
20.0	9.0	18.0	24.0	73.6	8.7	71.8	82.5
20.5	9.0	18.5	24.5	60.0	10.2	58.8	61.7
21.0	9.0	19.0	25.0	66.2	8.7	64.6	75.2
21.5	9.0	19.5	25.5	73.6	8.7	71.8	82.5
22.0	9.0	20.0	26.0	81.2	8.7	79.4	90.2
22.5	9.0	20.0	26.5	85.1	8.7	83.2	93.8
23.0	9.0	20.5	27.0	86.0	10.0	84.0	90.0
23.5	9.0	21.0	27.5	86.6	9.0	84.4	98.6
24.0	9.0	21.5	28.0	101.8	9.0	99.5	113.8
24.5	9.0	22.0	28.5				